

PART NUMBER	A	B	C
SLD-13-	?	?	?

Thermo-couple Type	Material	Max Temp Range
E	Chromega®/Constantan	900°C (1652°F)
J	Iron / Constantan	750°C (1382°F)
K	Chromega® / Alomega®	125°C (2282°F)

Standard Tip Material:
Molybdenum (Mo)

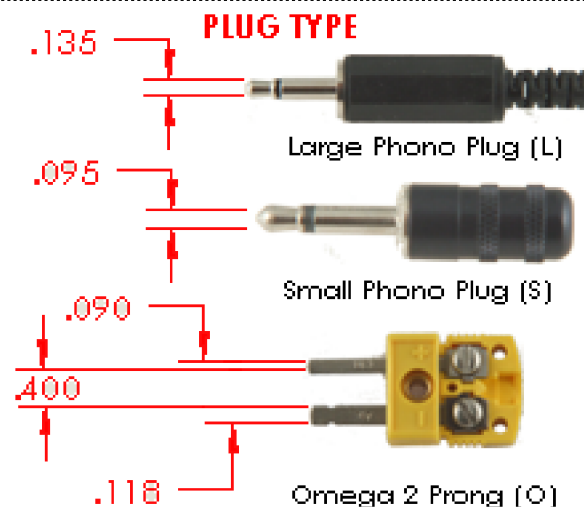

Part Number Construction
SLD-13-Mo-A2.00B.535C.125-J-O

Plug Type
Thermocouple
Dimensions
Material
Product Series

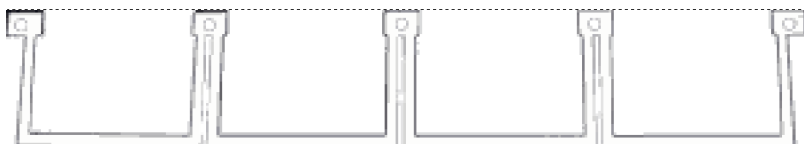
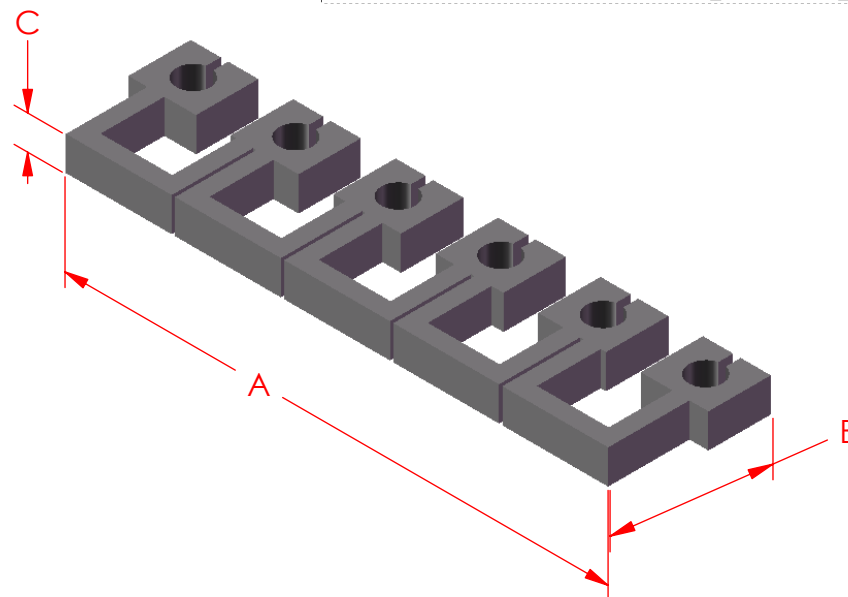

Custom configurations and Materials
available.
Contact the factory for assistance.

AIT PROPRIETARY THIS DOCUMENT AND THE DATA DISCLOSED HEREIN OR HEREWITH IS NOT TO BE REPRODUCED, USED OR DISCLOSED IN WHOLE OR IN PART TO ANYONE WITHOUT WRITTEN PERMISSION OF AIT		DIMENSIONS ARE IN INCHES DIMENSIONING & TOLERANCING PER ANSI Y14.5 UNLESS OTHERWISE SPECIFIED: TOLERANCES .X = .1 .XX = .01 .XXX = .005 .XXXX = .0005 ANGLES = 0°30' BREAK SHARP EDGES .010-.020 ALL SMALL FILLETS .020-.040 ALL FINISHED SURFACES 125		SIGNATURE DRAWN CHECKED ENGINEER		DATE		Microtronic GmbH www.microtronic.de	
MC THIRD ANGLE PROJECTION 3D				DO NOT SCALE DRAWING		SCALE: 1/1		DESCRIPTION SLD-13	
SIZE A		JOB NUMBER		DRAWING NUMBER SLD-13		REV A		SHT 1 OF 1	